

# Multi-purpose Cleaner Concentrate



## Product Usage Guide

Professional



### BA010-5



#### Health & Safety

Please refer to relevant COSHH Safety Data Sheet



Scan for further product details

#### Spray Cleaning



**1** Use appropriate PPE as indicated in the Safety Data Sheet and place Safety Signs.

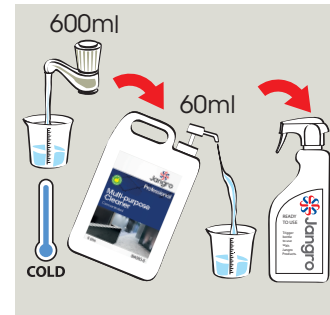

**2** Add up to 60ml of solution to 600ml of cold water in a trigger spray. Reduce dosage for light cleaning tasks.



**3** Replace top & gently shake to mix.

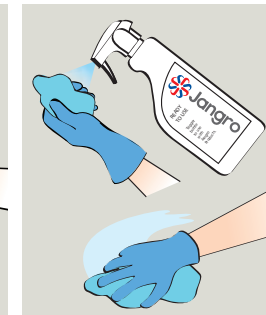

**4** Spray cloth and wipe surface.



**5** Remove Safety Signs.

#### Damp Mopping



**1** Use appropriate PPE as indicated in the Safety Data Sheet and place Safety Signs.

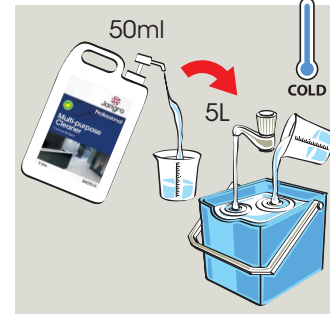

**2** Dilute 50ml of Solution per 5 litres of cold water in a bucket.

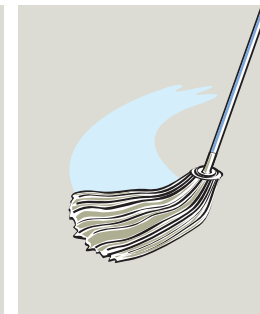

**3** Mop surface.

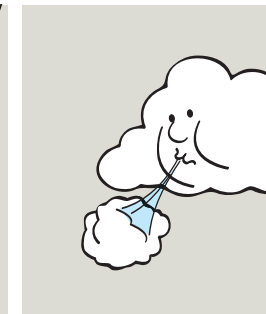

**4** Allow to air dry.



**5** Remove Safety Signs.