

# Hard Surface Cleaner



## Product Usage Guide



### BA001-5



#### Heavy Dirt and Grease



**1** Use appropriate PPE as indicated in the Safety Data Sheet and place Safety Signs.



**2** Remove loose debris from surface by sweeping or using a cloth or tissue.

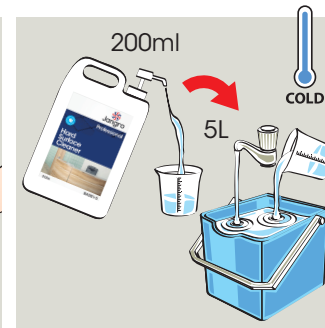

**3** Dilute 200ml per 5 litres of cold water.



**4** Wipe with mop or cloth.



**5** Once surface is dry, remove Safety Signs.

#### General Cleaning



**1** Use appropriate PPE as indicated in the Safety Data Sheet and place Safety Signs.



**2** Remove loose debris from surface by sweeping or using a cloth or tissue.

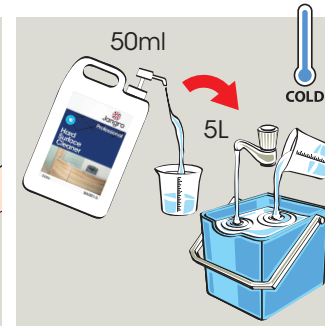

**3** Dilute 50ml per 5 litres of cold water.

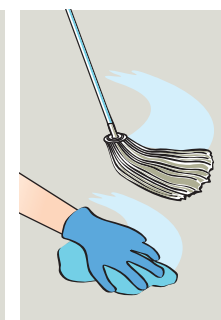

**4** Wipe with mop or cloth.



**5** Once surface is dry, remove Safety Signs.

#### Health & Safety

Please refer to relevant COSHH Safety Data Sheet



Scan for further product details