

Enviro All Purpose Cleaner



Product Usage Guide

enviro



BF060-5



Spray Cleaning



- 1 Use appropriate PPE as indicated in the Safety Data Sheet.
- 2 Place Safety Signs.
- 3 Dilute 6ml of solution per 600ml of cold water in a trigger spray.
- 4 Spray solution onto cloth.
- 5 Wipe surface.
- 6 Once dry remove Safety Signs.

Mopping

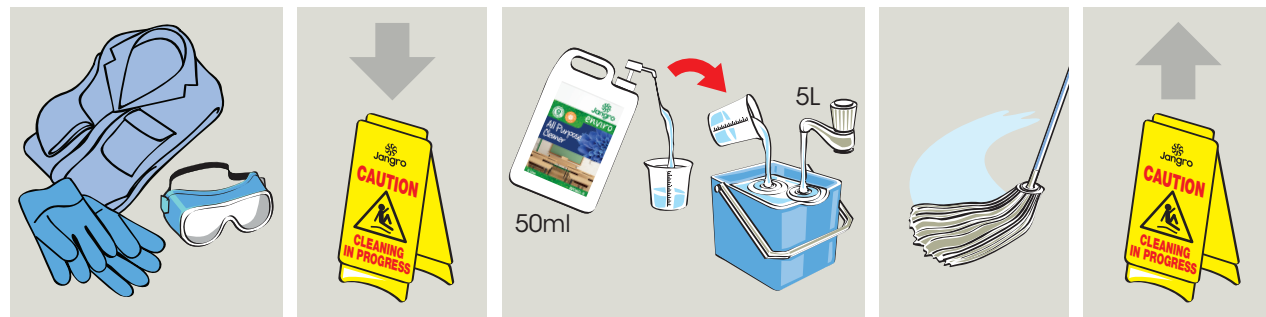

- 1 Use appropriate PPE as indicated in the Safety Data Sheet.
- 2 Place Safety Signs.
- 3 Dilute 50ml per 5 litres water in bucket.
- 4 Mop surface.
- 5 Once dry remove Safety Signs.

Health & Safety

Please refer to relevant COSHH Safety Data Sheet



Scan for further product details